

Transformateurs D'enseignes

REFERENCE : TEL1.5KV25mADP

PRIMAIRE : 230V
SECONDAIRE : 1500V
INTENSITE SECONDAIRE : 25mA
PROTECTION : Double protection



DIMENSIONS

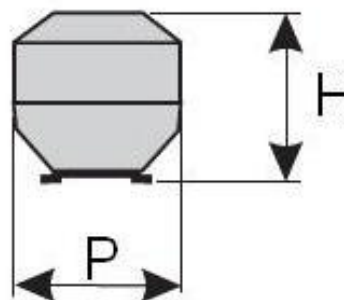
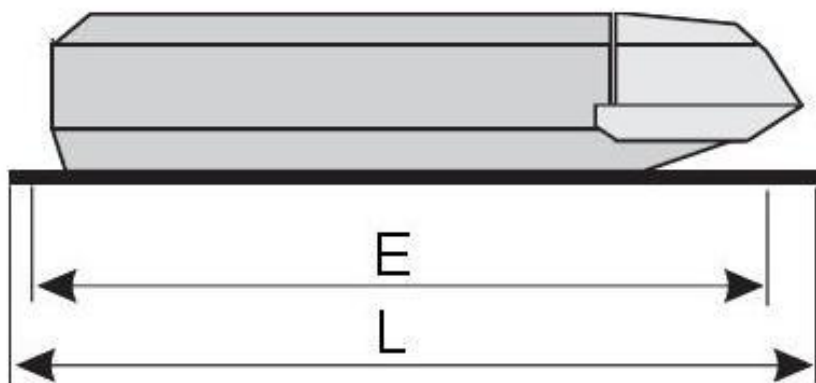

L	P	H	E	F	Diam.	Poids
322.	90.	69.				3.2

DIMENSIONS EN MM - POIDS EN Kg